

# Maldives Land and Survey Authority,

## MINISTRY OF HOUSING AND INFRASTRUCTURE

Ameenee Magu, Maafannu, Male', 20392, Maldives.

Office (PABX): +(960) 3004300, Fax: +(960) 3004254

Email: survey@mhe.gov.mv

Web: www.surveyofmaldives.gov.mv, www.mhe.gov.mv



<b>CONTROL POINT DETAILS</b>	<b>Station Number</b> PSM 5589
<b>Coordinate Information</b>	
<b>Geodetic</b>	<b>Grid</b>
<b>WGS 84</b>	<b>UTM Zone 43</b>
Lat: 5° 31' 16.97743" N	E: 327439.3846m
Long: 73° 26' 32.10271" E	N: 610523.3571m
Ellp Height:	Orth Height: 0.961m
<b>Island Name:</b> LH.HURAVALHI	<b>Date:</b> 31st October 2014

### Monument description & method of survey:

- o Type A monument
- o Stainless steel plate fixed to concrete by two bolts
- o Horizontal coordinates fixed by GNSS static survey
- o Elevation reduced relative to local MSL by double level run
- o The top level of the PSM is 150mm above ground level

### General site condition & access:

- o PSM5589 was established in the vegetation line of the island.
- o PSM5589 is located in an area which is easy to access and locate
- o PSM5589 on Eastern side of the island

Owner: **CHAMPA LARS HOLDINGS PVT.LTD.**



Bottom



North

Height 1.5m  
Distance 2.5m



East

Height 1.5m  
Distance 2.5m



Up



South

Height 1.5m  
Distance 2.5m



West

Height 1.5m  
Distance 2.5m

**SITE INFORMATION**

Station Number

PSM 5589

Station Horizon Mask

Locality

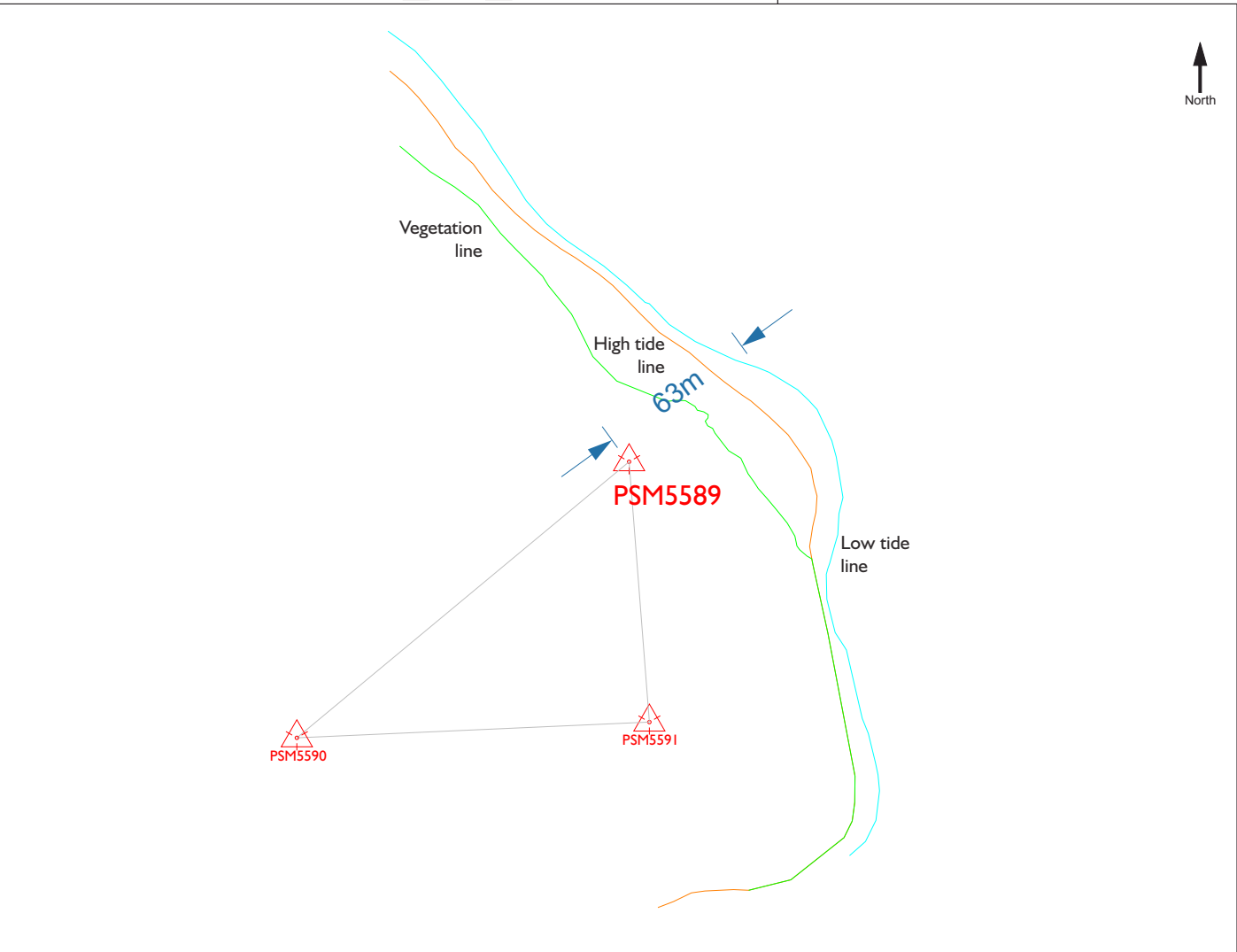
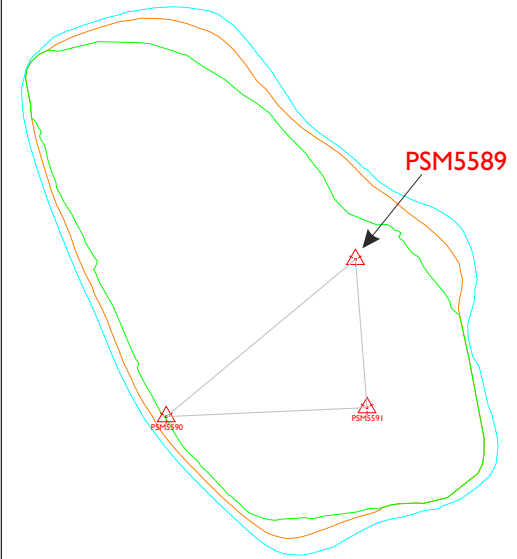
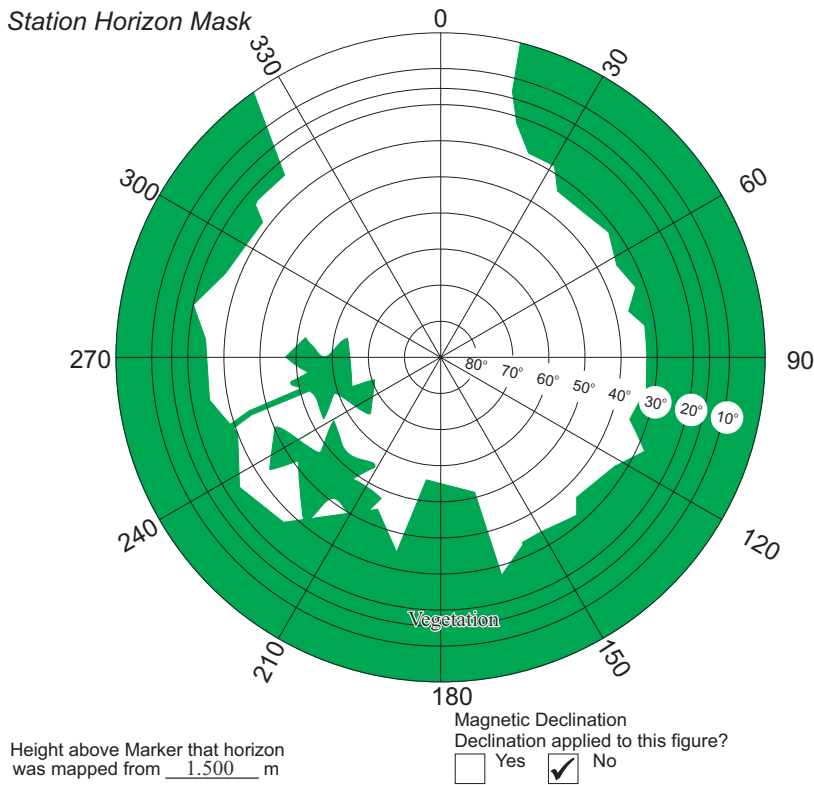

Sketched by: Shafee

Scale: Not to scale

Date: Oct. 2014

# Maldives Land and Survey Authority,

## MINISTRY OF HOUSING AND INFRASTRUCTURE

Ameenee Magu, Maafannu, Male', 20392, Maldives.

Office (PABX): +(960) 3004300, Fax: +(960) 3004254

Email: survey@mhe.gov.mv

Web: www.surveyofmaldives.gov.mv, www.mhe.gov.mv



<b>CONTROL POINT DETAILS</b>	<b>Station Number</b> PSM 5590
<b>Coordinate Information</b>	
<b>Geodetic</b>	<b>Grid</b>
<b>WGS 84</b>	<b>UTM Zone 43</b>
Lat: 5° 31' 13.40961" N	E: 327307.8610m
Long: 73° 26' 27.83880" E	N: 610414.1081m
Ellp Height:	Orth Height: 1.303m
<b>Island Name:</b> LH.HURAVALHI	<b>Date:</b> 31st October 2014

### Monument description & method of survey:

- o Type A monument
- o Stainless steel plate fixed to concrete by two bolts
- o Horizontal coordinates fixed by GNSS static survey
- o A level double run was recorded using PSM5589 as the base, vertical control levels of PSM5590 was determined from the level circuit
- o The top level of the PSM is 150mm above ground level

### General site condition & access:

- o PSM5590 was established in the vegetation line of the island
- o PSM5590 is located in an area which is easy to access and locate
- o PSM5590 on South western side of the island

Owner: CHAMPA LARS HOLDINGS PVT.LTD.



Bottom



North

Height 1.5m  
Distance 2.5m



East

Height 1.5m  
Distance 2.5m



Up



South

Height 1.5m  
Distance 2.5m



West

Height 1.5m  
Distance 2.5m

**SITE INFORMATION**

Station Number

PSM 5590

Station Horizon Mask

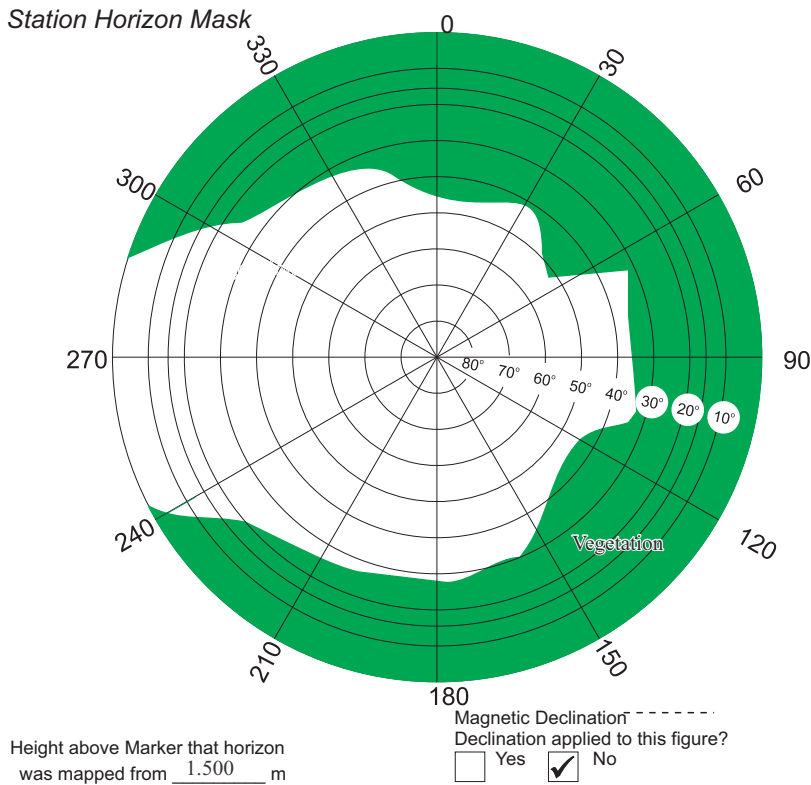

Locality

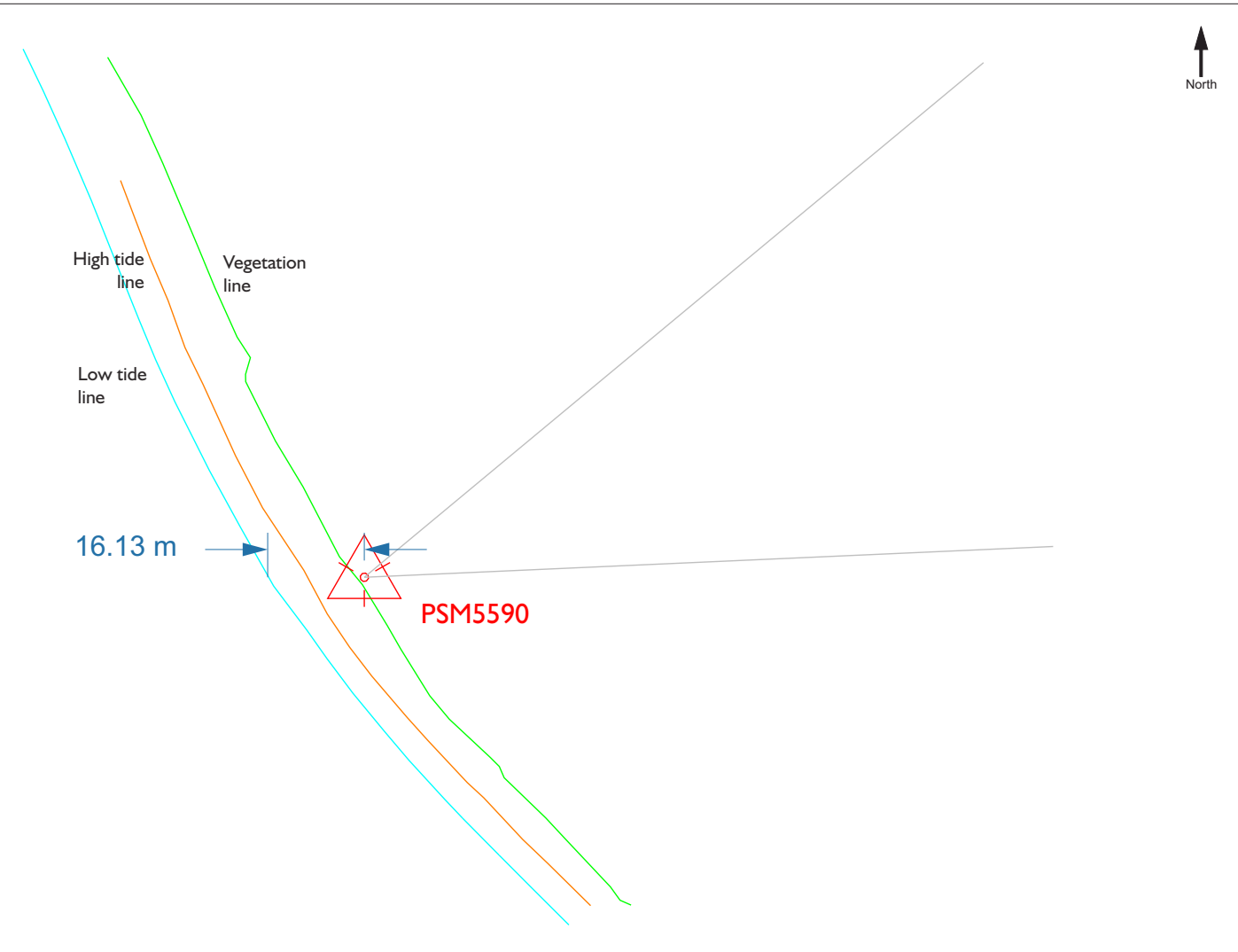
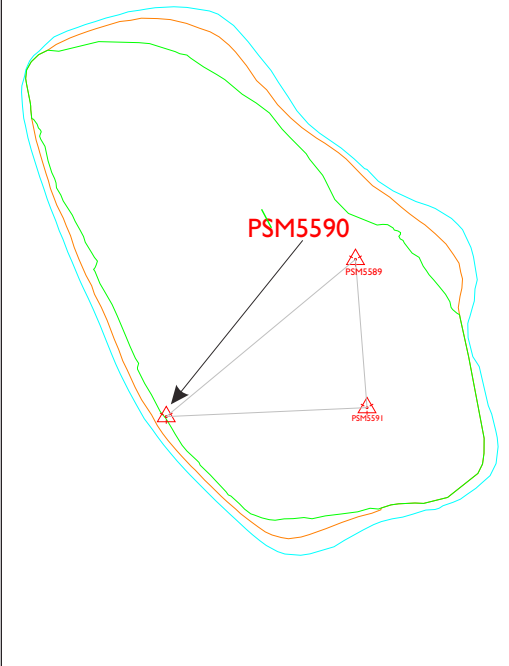

Sketched by: Shafec

Scale: Not to scale

Date: Oct. 2014



# Maldives Land and Survey Authority,

## MINISTRY OF HOUSING AND INFRASTRUCTURE

Ameenee Magu, Maafannu, Male', 20392, Maldives.

Office (PABX): +(960) 3004300, Fax: +(960) 3004254

Email: survey@mhe.gov.mv

Web: www.surveyofmaldives.gov.mv, www.mhe.gov.mv



<b>CONTROL POINT DETAILS</b>	<b>Station Number</b> PSM 5591
<b>Coordinate Information</b>	
<b>Geodetic</b>	<b>Grid</b>
<b>WGS 84</b>	<b>UTM Zone 43</b>
Lat: 5° 31' 13.62442" N	E: 327447.4163m
Long: 73° 26' 32.37241" E	N: 610420.3413m
Ellp Height:	Orth Height: 1.348m
<b>Island Name:</b> LH. HURAVALHI	<b>Date:</b> 31st October 2014

### Monument description & method of survey:

- o Type A monument
- o Stainless steel plate fixed to concrete by two bolts
- o Horizontal coordinates fixed by GNSS static survey
- o A level double run was recorded using PSM5589 as the base, vertical control levels of PSM5591 was determined from the level circuit.
- o The top level of the PSM is 150mm above ground level

### General site condition & access:

- o PSM5591 was established in the vegetation line of the island.
- o PSM5591 is located in an area which is easy to access and locate.
- o PSM5591 on South eastern side of the island

Owner: CHAMPA LARS HOLDINGS PVT.LTD.



Bottom



North

Height 1.5m  
Distance 3.0m



East

Height 1.5m  
Distance 3.0m



Up



South

Height 1.5m  
Distance 3.0m



West

Height 1.5m  
Distance 3.0m

**SITE INFORMATION**

Station Number

PSM 5591

Station Horizon Mask

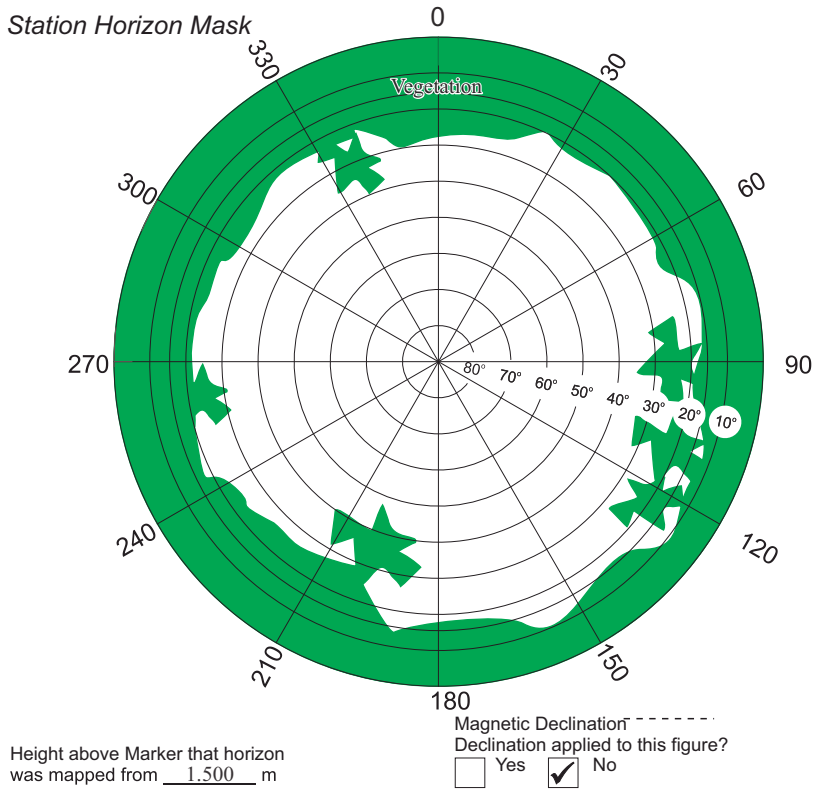

Locality

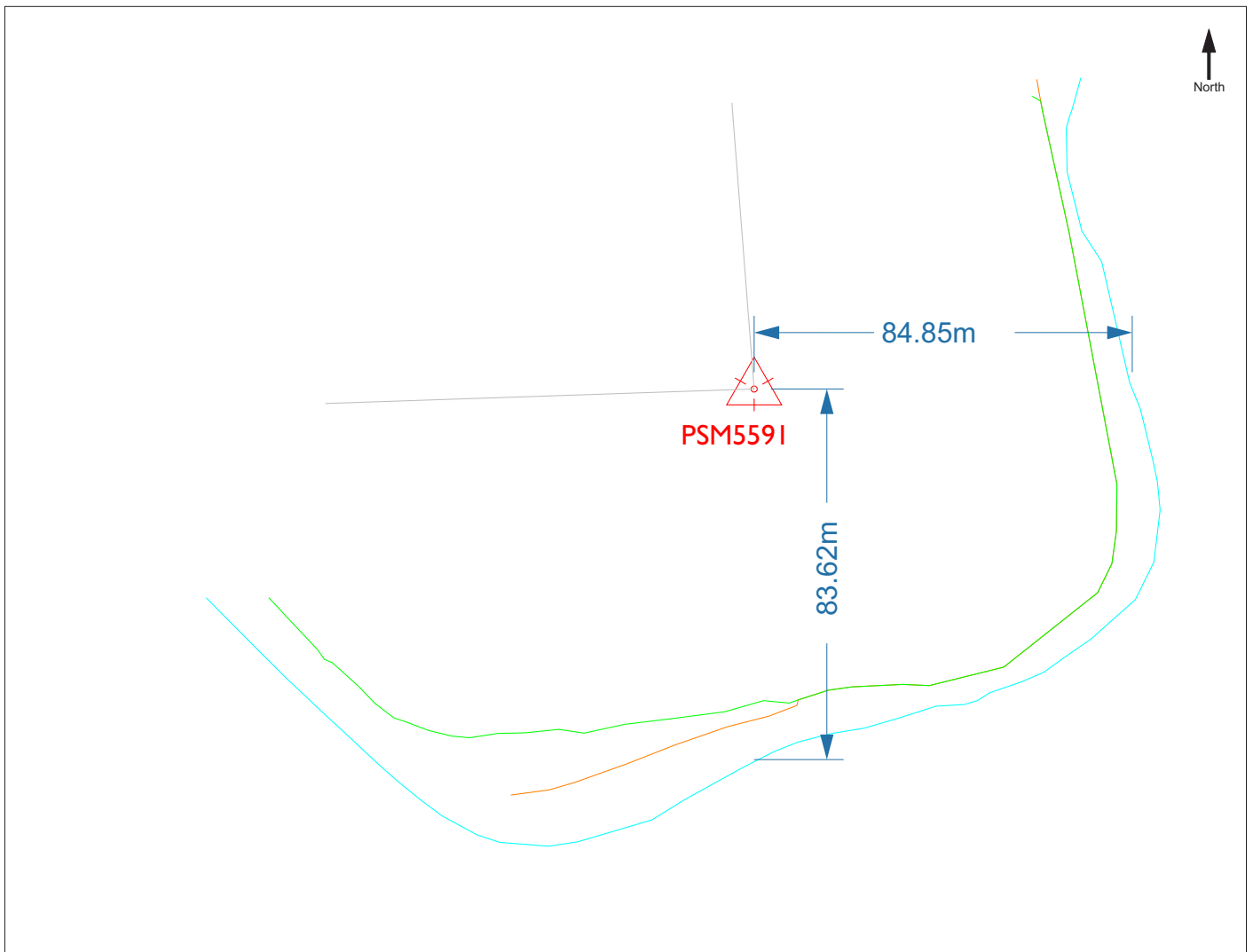
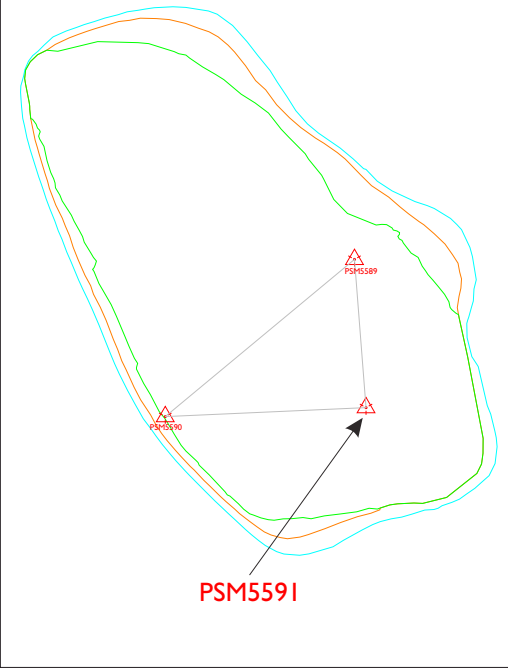

Sketched by: Shafec

Scale: Not to scale

Date: Oct. 2014